

IMPORTANT:

**PLEASE REVIEW AND
UNDERSTAND THESE
INSTRUCTIONS BEFORE
INSTALLING THE LOCKING DEMO
CABINETS.**

**PLEASE SAVE THIS INSTRUCTION
PACKET FOR FUTURE
REFERENCE.**

PGA Tour Superstore

Locking Demo Cabinet Installation Instructions PLEASE READ INSTRUCTIONS BEFORE PROCEEDING

After cabinet arrives at store, unpack and locate to installation area in store

Locking Demo Cabinet Installation Instructions



Locking Demo Cabinet



Step 1

After cabinet has been located to final installation area in the store, open bottom drawer and remove contents located in drawer.

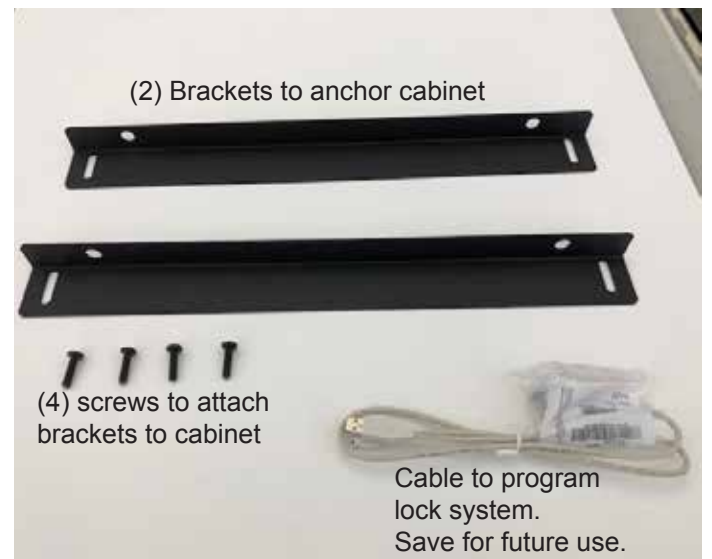

Step 1a

Unwrap contents from bottom drawer.

VERY IMPORTANT: WHEN REMOVING OR REPLACING DRAWERS PLEASE SEE ATTACHED INSTRUCTIONS.



Step 2

If cabinet has to be leveled, remove bottom drawer. Remove bottom drawer by pressing black catch buttons on drawer slides and pulling drawer out.



Step 2a

Pull drawer out evenly. DO NOT FORCE!



Step 2b

(4) levelers are now accessible. Use only levelers needed.



Step 2c

Install drawer back into cabinet. Make sure to align drawer rails with drawer slides on cabinet. DO NOT FORCE OR DAMAGE COULD OCCUR. SEE ATTACHED WARNING SHEET.



Step 3

Using the lock keypad, enter the Supervisor Code provided by PGATSS Visual Merchandising Team and press the Enter button, and pull open the top Drawer.



Step 4

With the top Drawer open, remove the red clips on both right and left sides of the drawer.



Step 4a

Both red clips must be removed before proceeding. Red clips can be discarded, they will not be reused.



Step 5

Drawers are installed with an 'Interlock' system. This system allows only one drawer to open at a time after lock code is entered and lock system engages.



Step 6

It is highly recommended to anchor the cabinet to the floor using the brackets provided, (removed from bottom drawer in step 1). Please use appropriate floor anchors for your flooring (Not provided).

There are (2) options to anchor the cabinet to the floor.



Step 6a

Option 1. Use (2) brackets, 1 on each right and left side of cabinet base. Brackets attach to cabinet using screws provided.



Step 6b

Option 2. Use (1) bracket on the rear base of cabinet. Brackets fasten to cabinet using screws provided.

Battery Changing Instructions

Follow these instruction to replace the batteries in the Locking Demo Cabinet.



Locking Demo Cabinet

Depending on usage, batteries should be changed approximately ONCE PER YEAR.



Step 1, 1a & 1b

Remove bottom drawer to access batteries by pressing black catch buttons on drawer slides and pulling drawer out.



Step 1a

Pull drawer out slowly and evenly. Do not force.



Step 1b

With bottom drawer removed, battery pack is now accessible.



Step 2 & 2a

Located in the bottom of the cabinet is the battery pack.



Step 2a

Slide the battery pack lock and the battery pack will be able to be pulled out. Remove batteries.

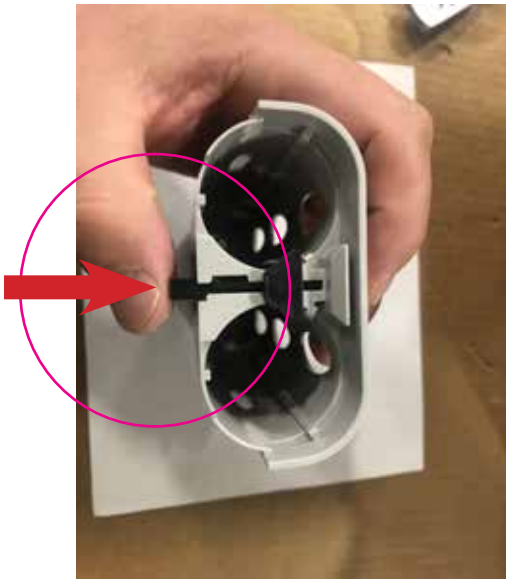

Step 3

Replace batteries by pressing black button on bottom of battery holder.



Step 4

Place battery pack back in to holder by making sure holder clicks back into place.



Step 5

Install drawer back into cabinet. Make sure to align drawer rails with drawer slides on cabinet. DO NOT FORCE OR DAMAGE COULD OCCUR. SEE ATTACHED WARNING SHEET.



Driver Heads (15 heads)

Driver Heads (15 heads)

Iron Heads (2 Vendor in 1 drawer, 56 heads)

Hybrids/Fairways (21 heads)

Hybrids/Fairways (21 heads)

Fitting Tools/Supplies

FINISHED DISPLAY

NOTE: PLEASE SAVE THIS INSTRUCTION PACK FOR FUTURE REFERENCE